

All parts glued with wood glue and fastened with 1 5/8" drywall screws. Predrill and countersink all holes then fill with wood filler after dry. Sand smooth, prime and paint.

Gluing is critical for long-term strength. Don't skip the glue!

Parts List - Parts cut from 3/4" pine unless noted

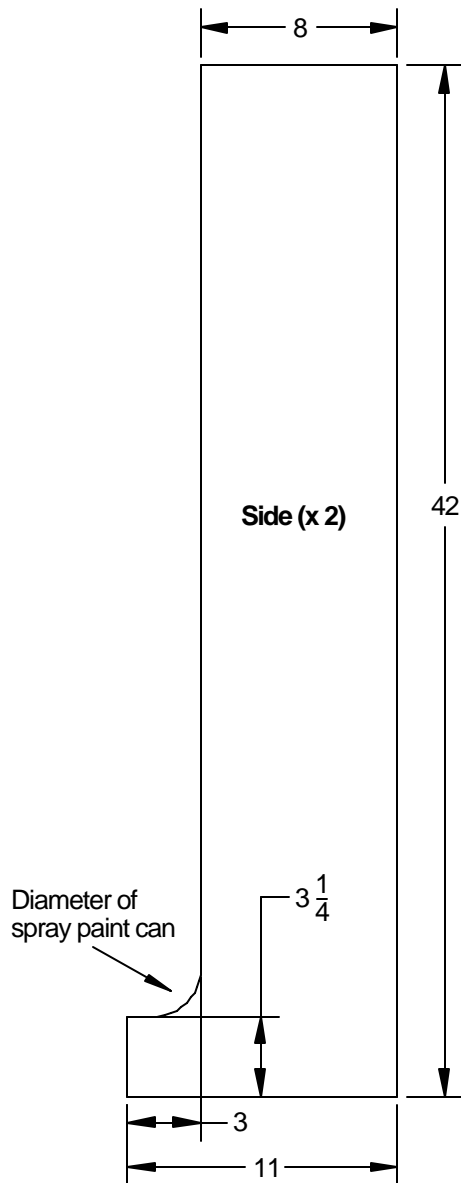

Hint: Set your table saw to 20 1/2" and cut all 20 1/2" parts in one session to ensure a precise, accurate fit. Then rip the boards to the proper width.

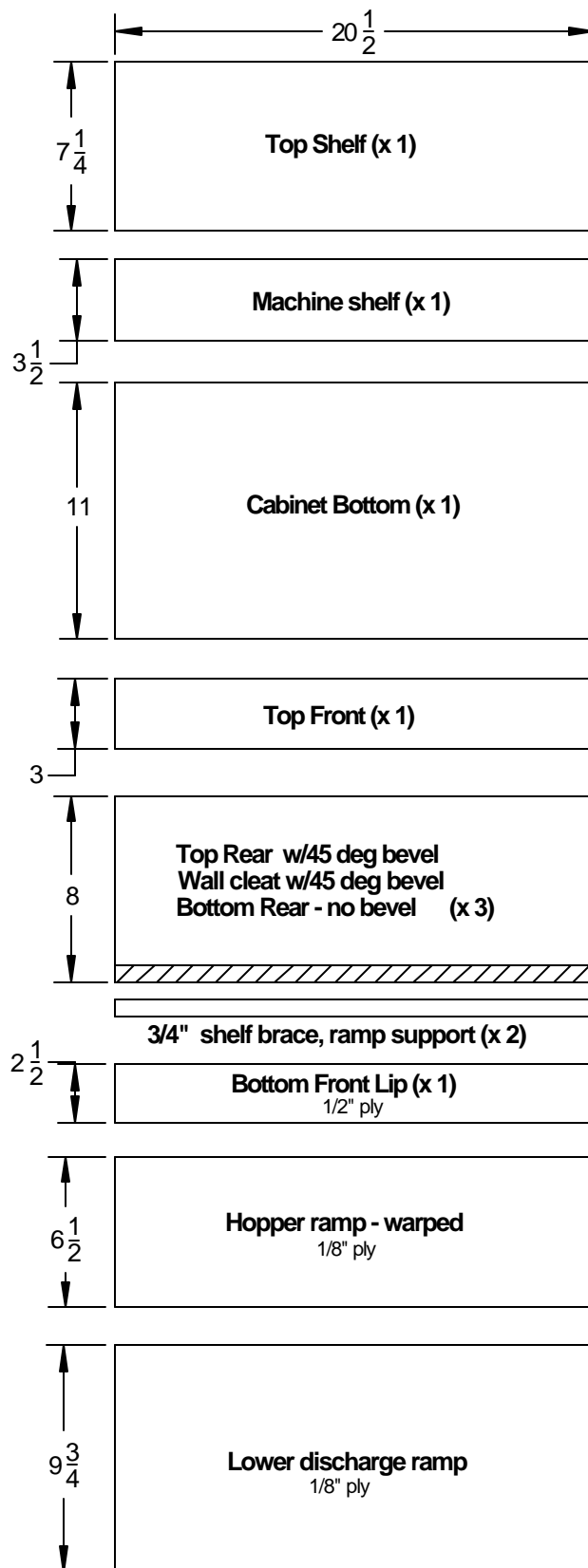

Plywood Slide Gate for 1 1/2" PVC down tube.

Constructed with 1/8" plywood and wood glue.
Cut holes in the three main pieces before gluing.

